

NOTES:

- EDGES OF EXISTING CARRIAGEWAY TO BE CUT BACK BY 0.5m WITH A ROTARY SAW TO FORM A VERTICAL FACE AND PRIMED IN ACCORDANCE WITH CLAUSE 920 NOTE 1.
- WHERE THE BASE COURSE IS TO BE LAID IN TWO LAYERS, THE UPPER LAYER OF BASE COURSE SHOULD BE STEPPED INTO THE EXISTING PAVEMENT BY 0.3m MIN. WITH THE BINDER COURSE AND SURFACE COURSE TO BE EACH STEPPED IN A FURTHER 0.3m MIN. RESPECTIVELY.
- ALL FACES OF COLD UPSTANDING EDGES SHALL BE TREATED TO CLAUSE 903.26 NOTE 1.

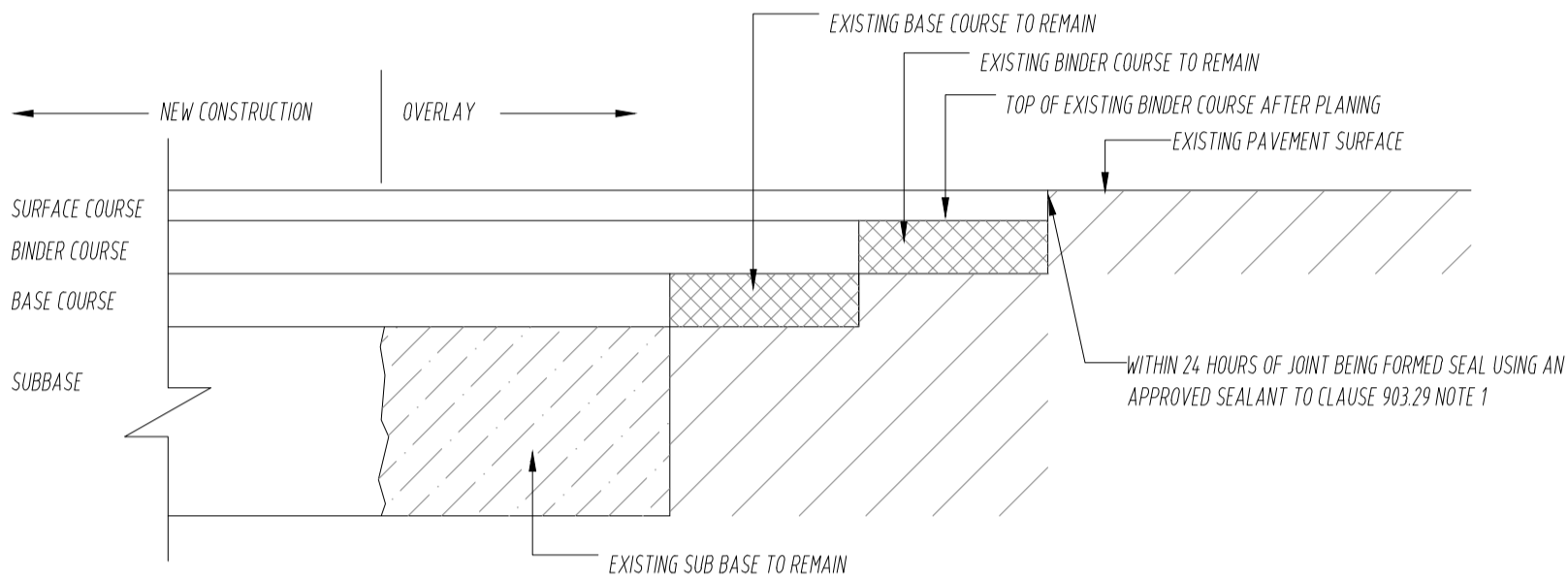

SECTION THROUGH NEW PUBLIC ROAD INFILL CONSTRUCTION AT LONGITUDINAL JOINT  
SCALE 1:10

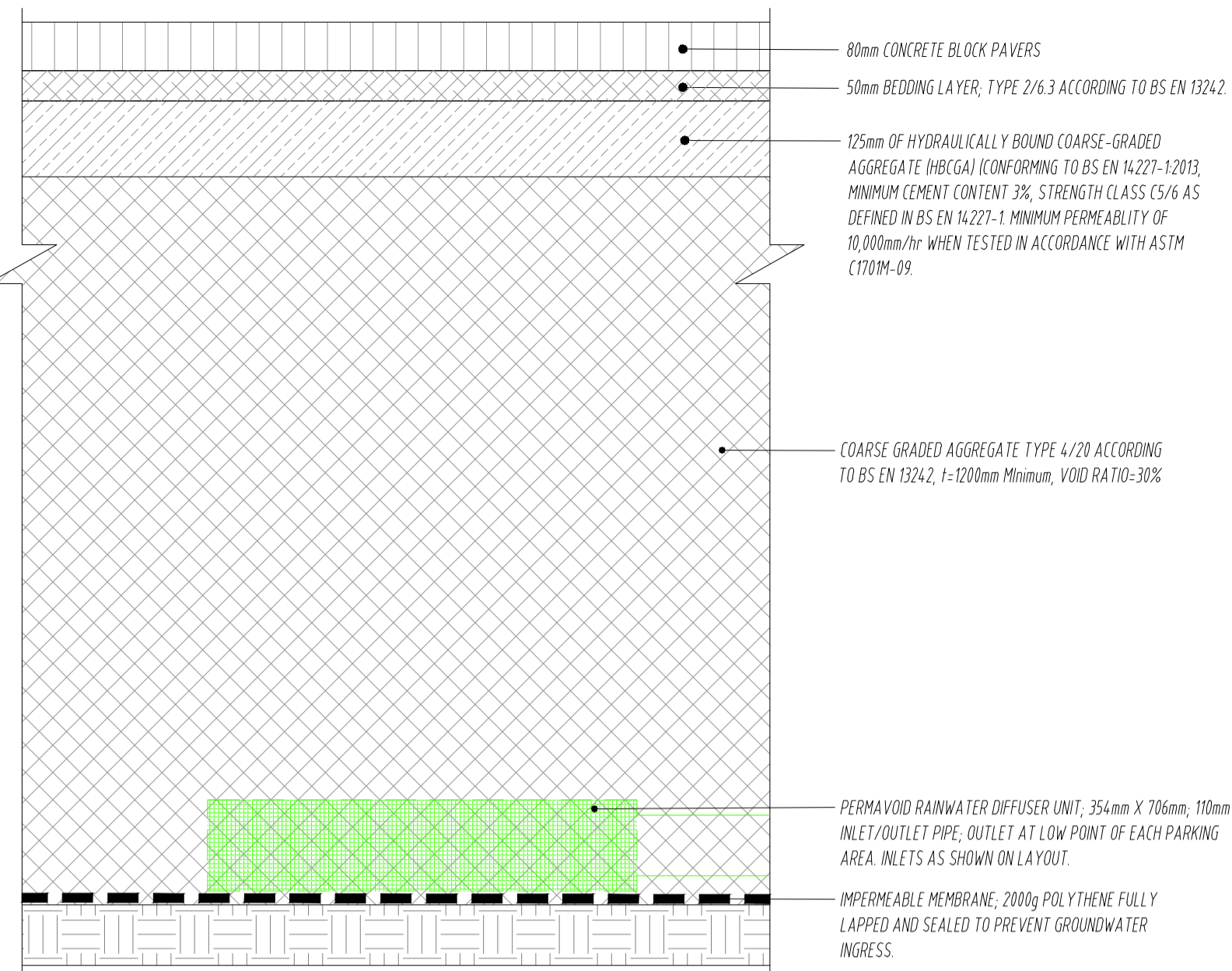

SECTION THROUGH PERMEABLE PAVING PARKING AREAS ADJACENT TO SITE ROADS  
SCALE 1:10

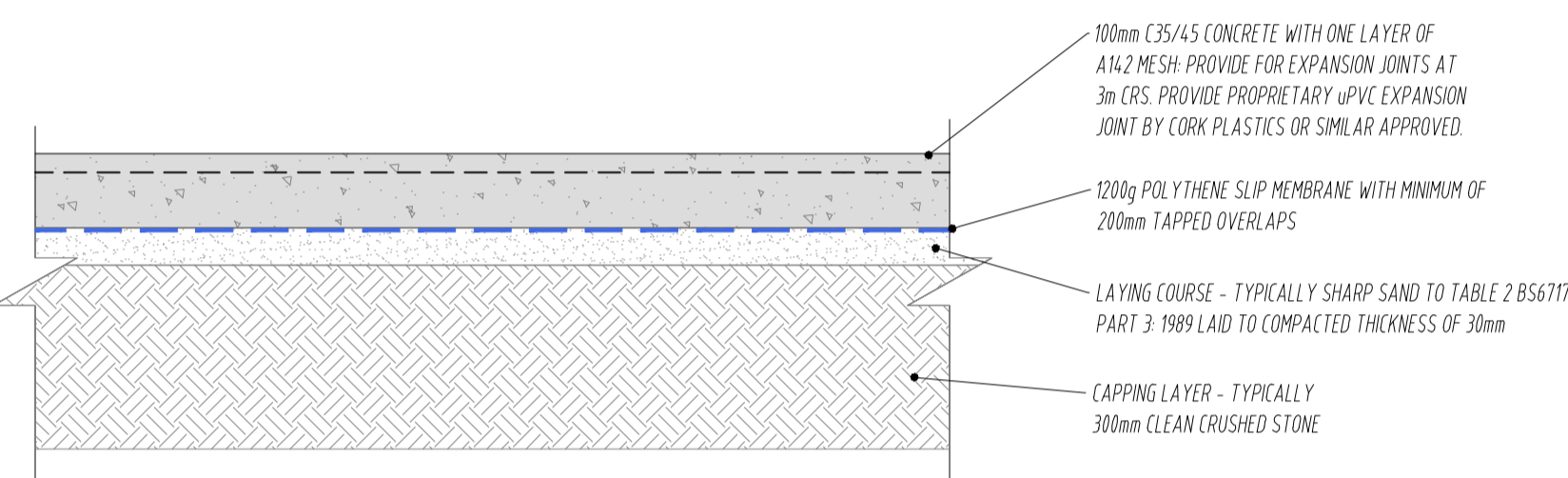

SECTION THROUGH CONCRETE FOOTPATHS  
SCALE 1:10

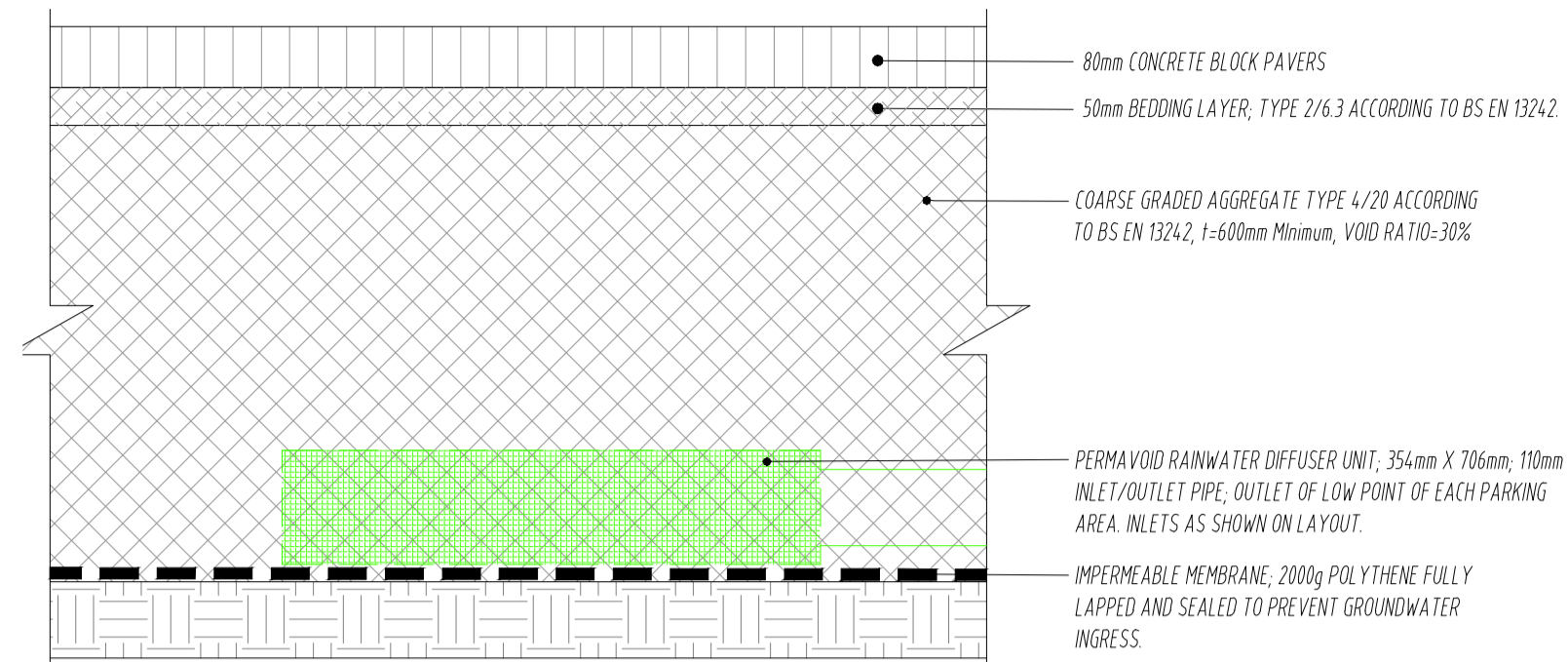

SECTION THROUGH PERMEABLE PAVING PARKING AREAS ADJACENT TO SITE ROADS  
SCALE 1:10

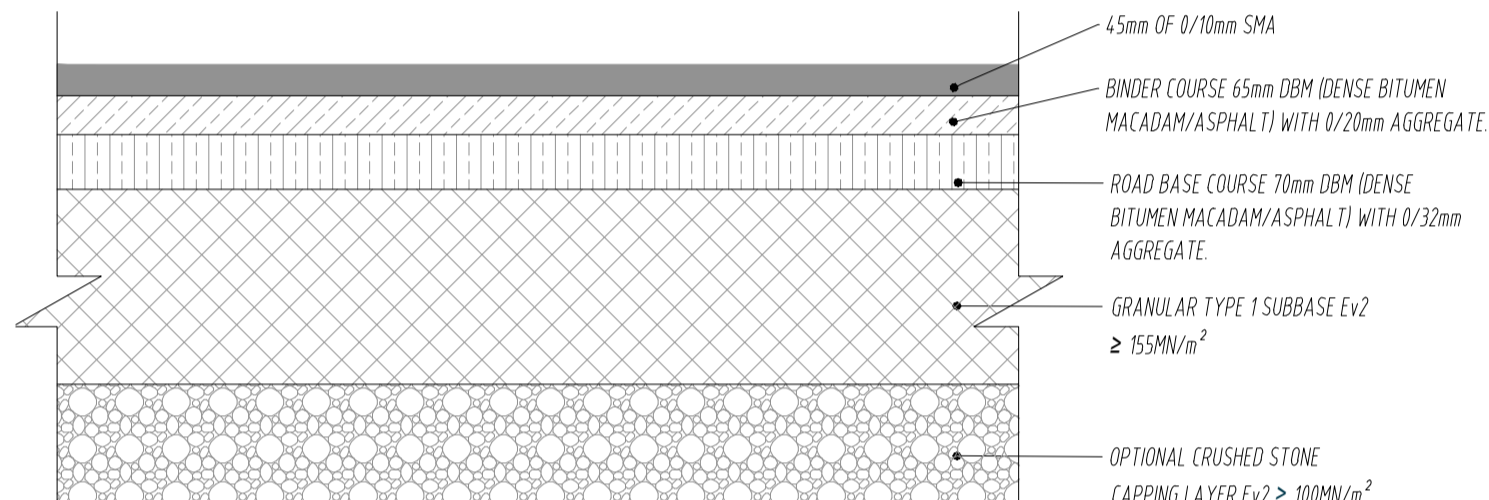

SECTION THROUGH SMA  
SCALE 1:10

FOR THICKNESSES OF CAPPING AND SUBBASE LAYER, SEE TABLE ABOVE

SUB BASE/CAPPING LAYER THICKNESS (BITUMINOUS OR BLOCK PAVED CONSTRUCTION)		
SUB GRADE CBR	SUB BASE ONLY OPTION	SUB BASE & CAPPING LAYER OPTION
2.5%	450mm SUB BASE	350mm SUB BASE + 250mm CAPPING LAYER
3.0%	420mm SUB BASE	320mm SUB BASE + 240mm CAPPING LAYER
4.0%	370mm SUB BASE	270mm SUB BASE + 230mm CAPPING LAYER
5.0%	330mm SUB BASE	240mm SUB BASE + 210mm CAPPING LAYER
>5.0%	250mm SUB BASE	

NOTE: FOR SUB GRADE CBR < 2.5% SPECIAL MEASURES MAY BE REQUIRED TO STABILISE THE SUB GRADE, TO BE AGREED WITH CLIENT ON A SITE SPECIFIC BASIS.

INTERNAL BUILDING GROUND FLOOR BUILD-UP:  
-RC FLOOR SLABS, INSULATION AND MEMBRANES TO ENGINEERS DETAILS  
-300mm SUB BASE HARD CORE FILL ROLLED IN LAYERS NOT EXCEEDING 200mm AND FULLY COMPACTED WITH A SUITABLE MECHANICAL ROLLER  
-CAPPING LAYER OF CRUSHED STONE TO THE FORMATION LEVEL ROLLED IN LAYERS NOT EXCEEDING 200mm AND FULLY COMPACTED WITH A SUITABLE MECHANICAL ROLLER  
-COMPACTION & SUBGRADE MODULUS TO BE ESTABLISHED BY APPROPRIATE INSITU TESTING. (PLATE BEARING TESTS WITH A PLATE DIA ≥ 600mm)

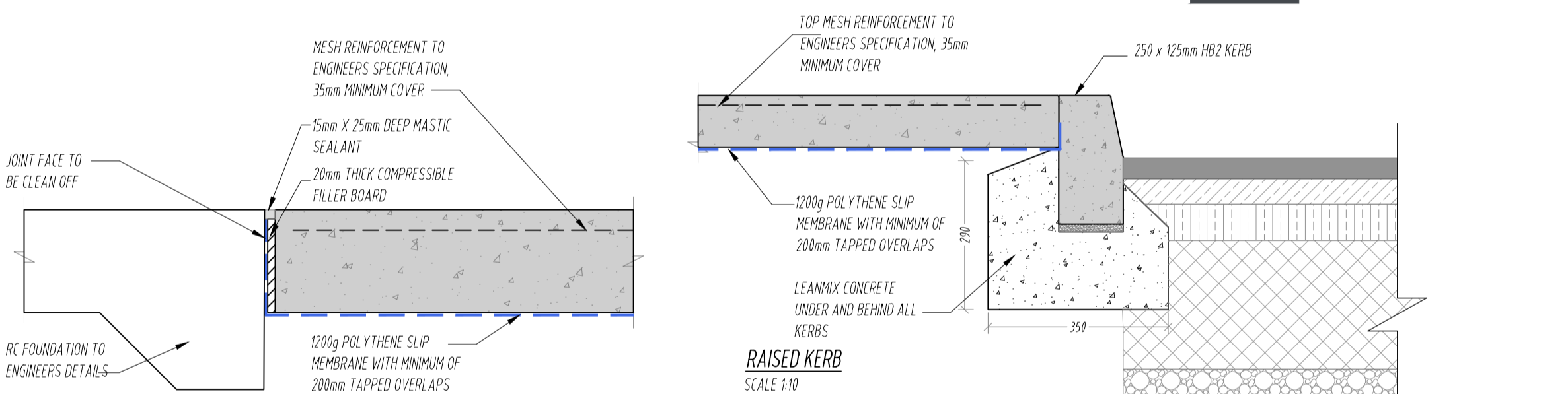

ISOLATION JOINT ADJACENT TO DWELLINGS  
SCALE 1:10

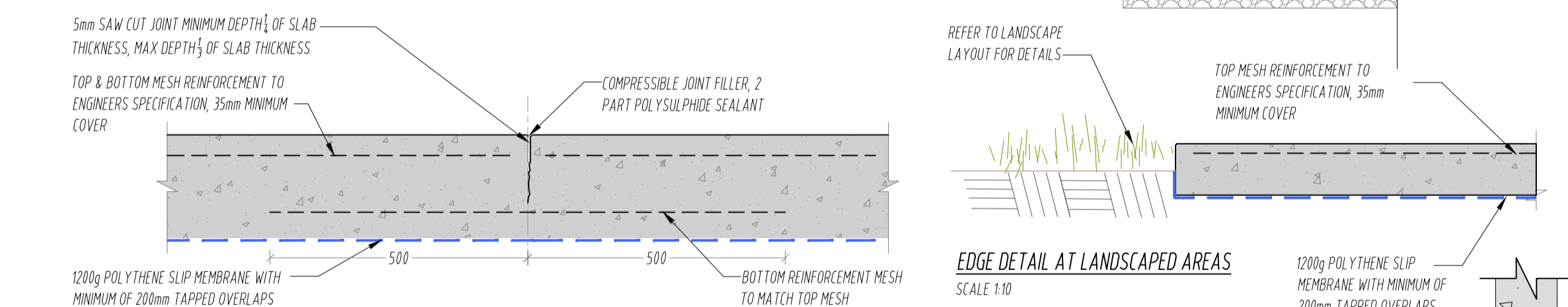

SAWN CONTRACTION JOINT (MAX SPACING= 6.0M)  
SCALE 1:10

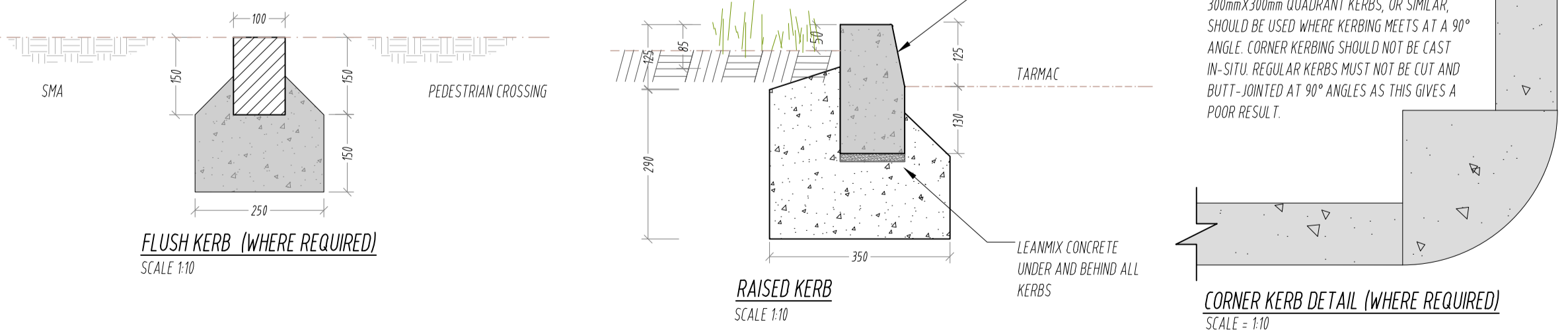

CORNER KERB DETAIL (WHERE REQUIRED)  
SCALE 1:10



TACTILE PAVING - TYPE 1  
TYPE 1 - RED TACTILE PAVING AT ALL SIGNALISED PEDESTRIAN CONTROLLED CROSSINGS ONLY.  
SCALE = 1:20



TACTILE PAVING - TYPE 2  
TYPE 2 - BUFF TACTILE PAVING AT ALL DISHD CROSSINGS.  
SCALE = 1:20

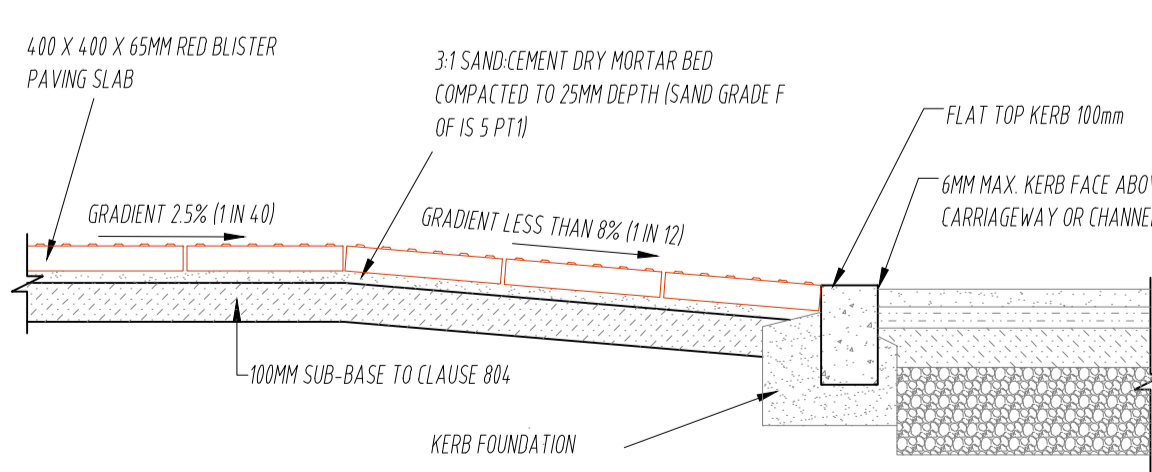

SECTION DETAIL THROUGH BLISTER PAVING  
SCALE = 1:20

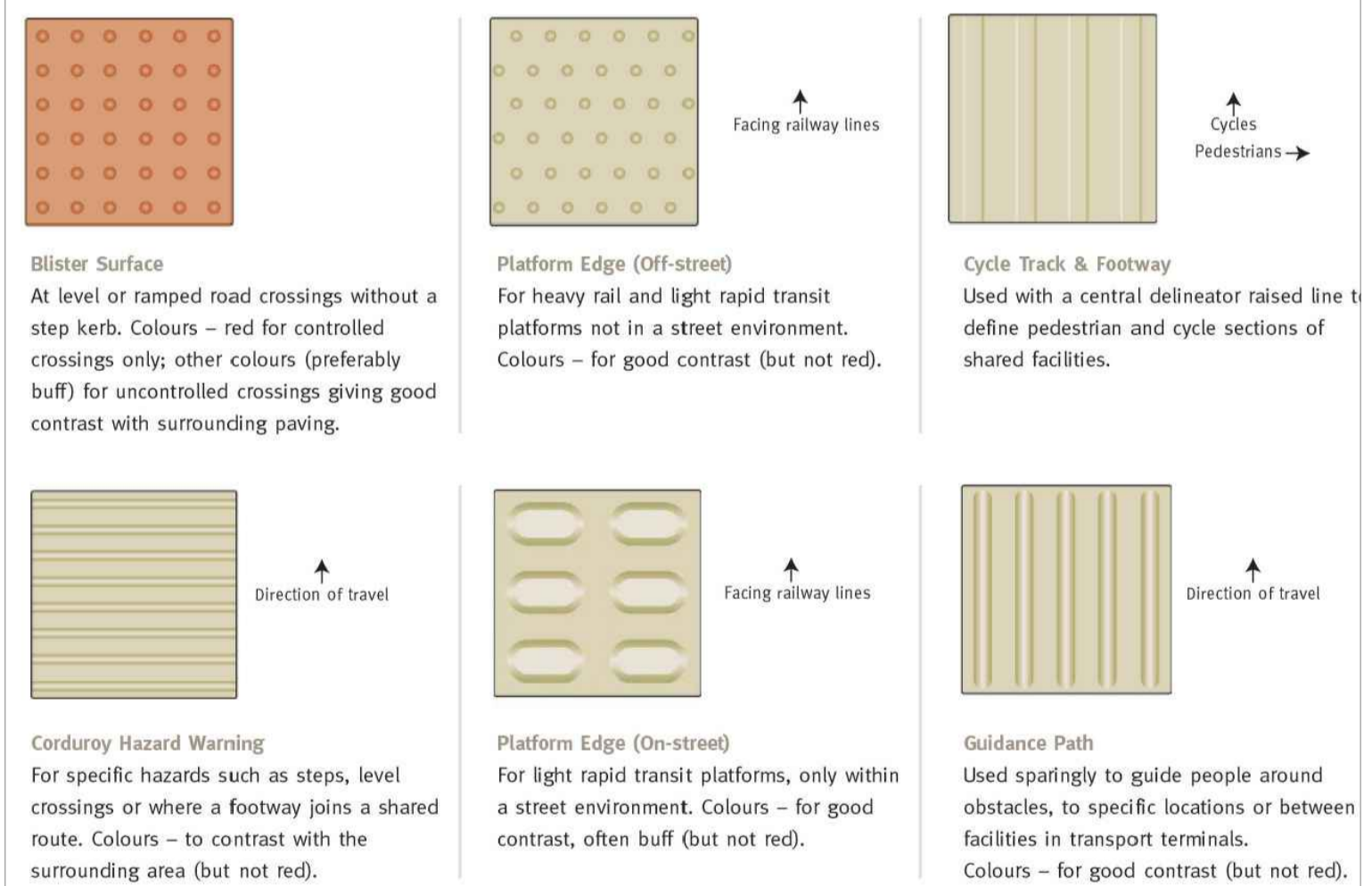

PEDESTRIAN & TRANSPORT INFRASTRUCTURE & OTHER APPLICATIONS  
SCALE = NTS

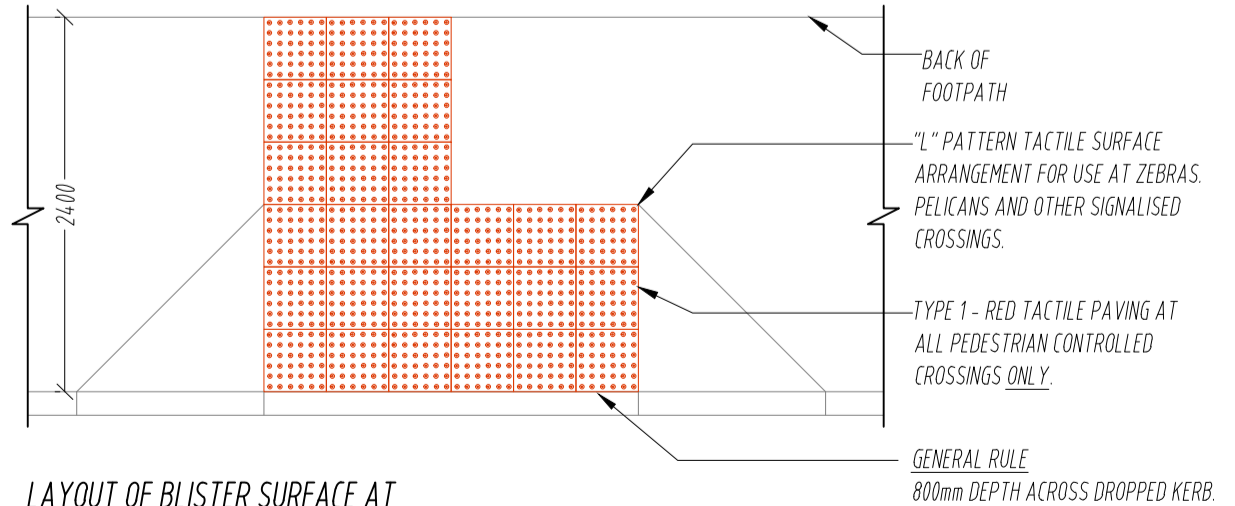

LAYOUT OF BLISTER SURFACE AT CONTROLLED CROSSING POINT.  
SCALE = 1:50

**DRAWING NOTES:** This drawing, the design and contents contained herein are copyright & may not be used without express permission of the authors. No part hereof may be copied or reproduced partially or wholly in any form whatsoever or stored in any retrieval system of any nature without the prior written consent of the copyright owners SDS (Structural Design Solutions) Ltd / SDS-UK (Structural Design Solutions) Ltd. NOTES: 1. This Drawing is to be read in conjunction with the relevant Specifications & other Architectural & Engineering Drawings. 2. Do Not Scale from this Drawing. -Metric Figured Dimension only to be used. 3. All dimensions to be checked on site prior to work commencing. 4. Engineers to be informed immediately of any discrepancies before work proceeds. 5. It is the Contractors responsibility to ensure that all works are carried out in accordance with the requirements of the current Building Regulations and all other statutory documents relevant to this project. 6. All details are standard, and are not project specific unless clearly stated otherwise. 7. Wherever a particular product is specified by name, the term "or equivalent subject to approval" is deemed inferred. The Contractor is obliged to ensure any and all products incorporated into a project are certified to the relevant National Standards (where necessary), are fit for their intended purpose and will provide adequate performance subject to manufacturers' warranties. 8. SDS (Structural Design Solutions) Ltd / SDS-UK (Structural Design Solutions) Ltd bear no liability for unilateral changes/modifications made during the course of construction based on the drawing prepared without prior consultation and confirmation of acceptance of revision by SDS (Structural Design Solutions) Ltd / SDS-UK (Structural Design Solutions) Ltd. 9. This drawing is to be read in conjunction with all relevant Architects drawings and Specifications. Any discrepancies identified are to be reported to the Engineers before proceeding.

**STRUCTURAL & CIVIL ENGINEERS**  
UNIT No. 9, HS BUSINESS PARK,  
CASTLEBAR, COUNTY MAYO, IRELAND.  
Tel: +353 (0)94-9034914 Fax: +353 (0)94-9034698  
E-mail: info@structuraldesign.ie Web: www.structuraldesign.ie

**SDS**  
Structural Design Solutions Ltd

REV.	DATE	BY	DESCRIPTION
PL1	17.02.2020	CD	Issued for Planning
PL2	09.02.2021	CD	Issued for Planning

**CONDORF INVESTMENTS IC&V**  
HOUSING DEVELOPMENT AT BALLINDERRY RD.,  
MULLINGAR, CO.WESTMEATH

External Pavement Details

Drawing Title

External Pavement Details

Scale

1:10

Page Size

@ A1

Status

PLANNING

Drawn by

FL

Date

FEBRUARY 2020

Checked

CD

Project No

18262

Drawing No

C130

Issue

PL2